

# ECOZEN

POOLS + LANDSCAPES



**Complete Pool + Landscape Packages**

**QUEENSLAND'S MOST AWARDED POOL BUILDER SINCE 1978**



# 3D DESIGN

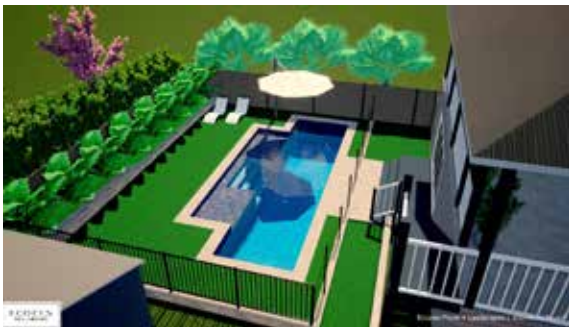

## Our designs are as individual as you are.

Every Ecozen project is customised, individually designed and professionally presented to you in a completed 3D render.

This allows you to get a real feel for the end product and to make any changes required to ensure the design exceeds your expectations.

We design our projects by considering your individual lifestyle, your family, your site, your home and how you will use your pool.

Our specialised team of award winning pool and landscape designers offer the latest in contemporary outdoor design, delivered to you with the professional service we are known for.

For a complimentary on site consultation, 3D design and a professionally itemised quote please contact us today on 1800 326 936 or [info@ecozen.com.au](mailto:info@ecozen.com.au)



# INTERIOR FINISHES



**Ecozen Aqua**



**Ecozen Champagne**



**Ecozen Azure**



**Ecozen Salt & Pepper**



**Ecozen Sky**



**Ecozen White**

*Please note: These pictures are indicative examples only of the water colours provided.  
The final water colour of each project will vary with the final tile choices and surrounding environment.*



## Standard Inclusions

- All engineering design, certification and council approvals with documentation provided.
- A provisional excavation and soil removal allowance for the pool excavation on your site.
- QBCC licensed pool and landscape builders with Master Builders and SPASA accreditation, Ecozen use SPASA contracts and Master Builders insurances for peace of mind in working with qualified, experienced industry professionals.
- Steel reinforced concrete pool in any shape. Let us design and build your dream pool.
- Play benches, resort steps and standard pool depths from 1.2m to 1.8m deep. Custom designs for your site, budget and family.
- Variable speed eco pumps and glass bead medium filters for energy efficiency. Quality equipment on every project.
- Deluxe skimmer box and oversized basket, high pressure 40mm pipes, eyeball covers, pressure release valve and pebbled main drain.
- Provisional plumbing included to the corner of the house for a future heating system. Solar heating, electric heating and gas heating packages available.
- Polished 1-2mm ocean pebble and quartz interior of the owner's choice. Glass bead interiors, tiled interiors and aqua neon options available.
- 400mm single bull nose coping of the owner's choice with a tiled skimmer box lid in the upgraded quad lid.
- LED Colour changing pool light, operated by the free pool remote control operating system.
- Salt water and mineral pool chlorinator with timer for an automatic pool balancing. Further mineral and fresh water options available for the latest in eco smart pool operating systems.
- Ceramic 300mm deep waterline feature tile band and 50mm bench/step tile highlights.
- Robotic automated pool cleaner for the pool floor and walls to keep your new pool clean.

**Peace of mind in building with Queensland's  
most awarded pool builder since 1978**



# PACKAGE DEALS

Contact Ecozen and let the professionals design and build your dream project today.



## Family Pool **\$55,000**

- 7m long x 3m wide
- 20 L/m
- Ecozen Standard Inclusions
- \$6,000 excavation allowance (waterline and robotic cleaner included)

## Resort Pool **\$65,000**

- 8m long x 4m wide
- 24 L/m
- Ecozen Standard Inclusions
- \$6,000 excavation allowance (waterline and robotic cleaner included)



## Entertainer Pool **\$70,000**

- 9m long x 4m wide
- 26 L/m
- Ecozen Standard Inclusions
- \$6,000 excavation allowance (waterline and robotic cleaner included)







## Building your pool at the same time as your new home

**Building your pool at the same time as your new home has many benefits.**

- Your new pool will be completed and ready for you to enjoy when you move in.
- The pool location can be optimised as part of the house design and left clear of pipes.
- You will save money on the pool excavation costs by installing the pool with the house build, as access can be greatly reduced after the house is built.
- No construction after the house completion disrupting your new home and landscaping.
- The filtration location, power, pipes, fencing and tiling can all be designed and considered at the same time as the house for a flawless finish and efficient construction.
- The end result will create a pool and landscape space that has been designed as part of the home not an afterthought. This allows us to match your style, materials and finishes.





## Some things to consider when building a pool at the same time as your house.

**POOL SAFETY COVER / TEMP FENCE** - Depending on the proximity of the pool to the house, the house builder may need the pool boarded/covered for the duration of the house build for safety. This is an additional expense that can be coordinated via your house builder or pool builder. Depending on the build time, temporary fencing may be needed for an extended time. The costs of covering and/or fencing the pool shell during the house build are usually made up for by the savings on the pool excavation costs by installing the pool before the house goes in. Having greater access for the pool dig saves you money.

**SURVEYING** - As there are generally no reference points when the pool is being profiled and positioned on site, you will may need to pay an additional surveying fee of approx \$500 to have the pool/boundary/house positions surveyed on site before the house build. This ensures the pool position and heights are accurate. If the boundaries are accurate the house builder may offer this as a free service.

**PIERING / FOUNDATIONS** - Depending on the proximity of the pool to the house, the new house may require piercing or additional foundations in places to allow for the pool. This is done through your house builder.

**PIPES / SERVICES** - Knowing the location of the pool early in your design process will allow you builder to keep all services and underground pipes clear of the pool zone.

**FILTRATION STATION LOCATION / BACK WASH** - Ideally, you will want to keep the pool filtration station within 10 metres of the pool and out of the pool zone. Your pool designer can help you with this design to ensure the best location on site. Keep in mind the heights of filtration equipment near windows and pool fences. You will want your house builder to install a back wash outlet/stormwater point at the filtration station.

**ELECTRICALS** - Your house builder will be able to provide power outlets at your filtration station location. This is usually 4 x 10amp outdoor power points. Your pool builder can confirm exact power requirements for your pool. Your pool electrical may also include earthing and garden lighting if required around the pool.

**TILES AND MATERIALS** - Picking your outdoor tiles / pavers early can assist with your pool design, as the size of the pool and the surrounds can be designed to match in with the house tiles for a sleek and modern look. By working with our landscape architects early we can ensure your pool and home are designed together as one complete space for your family to enjoy as soon as you move in.





ECOZEN  
POOLS + LANDSCAPES



**Queensland's most awarded pool builder since 1978.**



CLIMATECARE  
CERTIFIED

**Ecozen is proudly the first concrete pool builder in Australia to become Climate Care Certified.**

**With a climate care certified pool, pool owners are supported and empowered to reduce water and energy consumption with an environmentally sustainable swimming pool, whilst saving money at the same time.**

**1800 326 936 | [ecozen.com.au](http://ecozen.com.au)**

**ECOZEN PTY LTD T/A ECOZEN | QBCC Lic: 1204348**

***[info@ecozen.com.au](mailto:info@ecozen.com.au)***

ECOZEN  
POOLS + LANDSCAPES